

BUILDING DESIGN PARTNERSHIP SHALL HAVE NO RESPONSIBILITY FOR ANY USE MADE OF THIS DOCUMENT OTHER THAN FOR THAT WHICH IT WAS PREPARED AND ISSUED.
 ALL DIMENSIONS SHOULD BE CHECKED ON SITE.
 ANY DRAWING ERRORS OR OMISSIONS SHOULD BE BROUGHT TO THE ATTENTION OF BUILDING DESIGN PARTNERSHIP AT THE ADDRESS SHOWN BELOW.
 DRAWINGS SHALL BE READ IN CONJUNCTION WITH THE FOLLOWING BEFORE WORK COMMENCES:
 * THE SCM DESIGN ISSUES REGISTER
 * THE SCP RISK SERIES OF DRAWINGS
 * THE PROJECT SCM RISK REGISTER

NOTES

- Department colour key:
- Entrance
 - Outpatients
 - Radiology
 - Endoscopy
 - Theatres
 - Inpatients
 - Staff Facilities
 - FIM/General
 - Catering
 - Communication
 - Plant

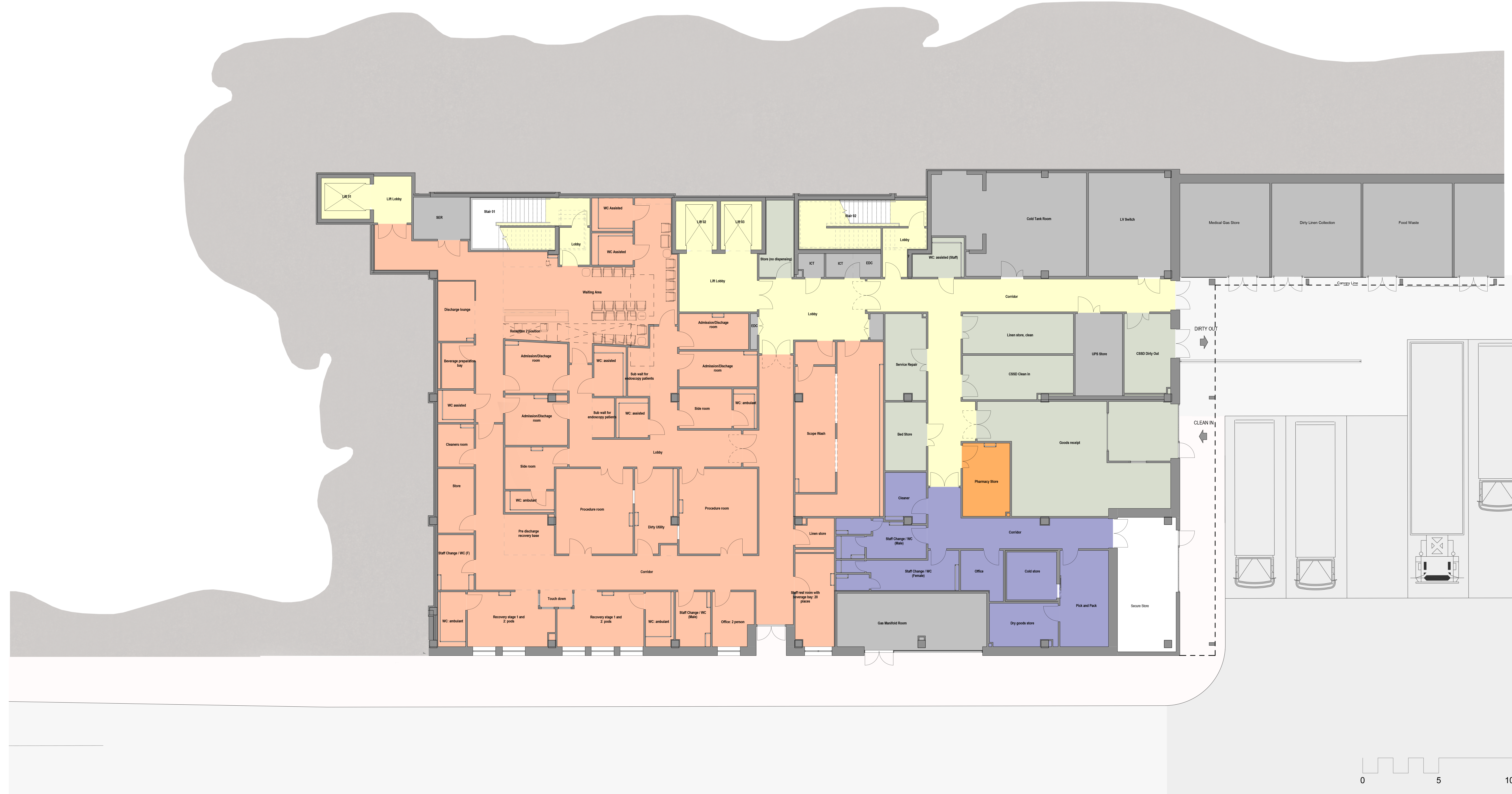

P02: Revised Planning Submission	M/M	SW	11/04/17
P01: FIRST ISSUE	M/M	SW	03/10/16

Frimley Health **NHS Foundation Trust**
 Frimley Park Hospital
 Portsmouth Road
 Frimley
 Surrey
 GU16 7JU

BDP.
 7 Hill Street
 Bristol
 BS1 5RW
 United Kingdom
 T +44 (0)117 929 9861
 F +44 (0)117 922 5280
 www.bdp.com

Heatherwood Hospital Redevelopment	
P2006781	@ A0
Hospital Building General Arrangement Plan Level 00	1:100
HHR-BDP-XX-00-PL-A-200001	03/10/16
P02	