

REPORT TO LICENSING PANEL SUB COMMITTEE.

CONSIDERATION OF APPLICATION FOR A NEW PREMISES LICENCE UNDER THE LICENSING ACT 2003

LICENSING PANEL SUB COMMITTEE: January 2019

OFFICER REPORTING: Steve Smith

A) The Application

Applicant: - Charul Patel

Premises: - Costcutter, 113-117 Springfield Road, Windsor, SL4 3 PZ

The application relates to an application for a new premises licence.

A summary of the application is as follows:-

The standard opening hours of the premises:

- 06.00 until 23.00 hrs Monday to Sunday

To permit the sale by retail of alcohol for consumption OFF the premises:

- 06.00 until 23.00 hrs Monday to Sunday

Designated Premises Supervisor (DPS): Charul Patel

This is a brand new application for a premises licence, the premises itself has not held a premises licence before, and to the best of our knowledge has been an electrical retail outlet for many years. The application has been made outside of the current framework hours within the RBWM licensing policy (this is detailed further within the report).

B) Relevant Representations

Responsible Authorities.

- | | |
|---|----------|
| a. Environmental Health (CPES): | None |
| b. RBFRS (Fire Officer): | None |
| c. Planning Officer: | None |
| d. Local Safeguarding Children's Board (LSCB) | None |
| e. Public Health: | None |
| f. Trading Standards: | Attached |
| g. Thames Valley Police: | None |
| h. RBWM Licensing: | None |

Trading Standards have requested a number of conditions relating to one of the four key objectives;- Prevention of children from harm - which is attached, however, these have been agreed by the applicant.

Interested Parties:

- 12 representations from local residents.
- Petition signed by 138 local residents.
- 02 representation from local ward Councilors.

C) It is considered that the following policies have a bearing upon the application.

182 National Guidance April 2018

The sub committee must have regard to the amended Secretary of States guidance issued in April 2018 under Section 182 of the Licensing Act 2003 and in particular Chapters 9 (Determining applications) and 10 (Conditions attached to Premises Licences). Particular regard should be had to paragraphs 9.31 – 9.41 (Hearings) and 9.42 – 9.44 (Determining actions that are appropriate for the promotion of the licensing objectives).

Also the following relevant sections

Crime and Disorder

2.1 Licensing authorities should look to the police as the main source of advice on crime and disorder. They should also seek to involve the local Community Safety Partnership (CSP).

2.3 Conditions should be targeted on deterrence and preventing crime and disorder including the prevention of illegal working in premises (see paragraph 10.10). For example, where there is good reason to suppose that disorder may take place, the presence of closed-circuit television (CCTV) cameras both inside and immediately outside the premises can actively deter disorder, nuisance, anti-social behaviour and crime generally. Some licence holders may wish to have cameras on their premises for the prevention of crime directed against the business itself, its staff, or its customers. But any condition may require a broader approach, and it may be appropriate to ensure that the precise location of cameras is set out on plans to ensure that certain areas are properly covered and there is no subsequent dispute over the terms of the condition.

2.5 Conditions relating to the management competency of designated premises supervisors should not normally be attached to premises licences. It will normally be the responsibility of the premises licence holder as an employer, and not the licensing

authority, to ensure that the managers appointed at the premises are competent and appropriately trained. The designated premises supervisor is the key person who will usually be responsible for the day to day management of the premises by the premises licence holder, including the prevention of disorder. A condition of this kind may only be justified as appropriate in rare circumstances where it can be demonstrated that, in the circumstances associated with particular premises, poor management competency could give rise to issues of crime and disorder and public safety.

2.6 The prevention of crime includes the prevention of immigration crime including the prevention of illegal working in licensed premises. Licensing authorities should work with Home Office Immigration Enforcement, as well as the police, in respect of these matters. Licence conditions that are considered appropriate for the prevention of illegal working in the licensed premises might include requiring a premises licence holder to undertake right to work check on all staff employed at the licensed premises or requiring that a copy of any documents checked as part of a right to work check are retained at the licensed premises.

Public nuisance

2.15 The 2003 Act enables licensing authorities and responsible authorities, through representations, to consider what constitutes public nuisance and what is appropriate to prevent it in terms of conditions attached to specific premises licences and club premises certificates. It is therefore important that in considering the promotion of this licensing objective, licensing authorities and responsible authorities focus on the effect of the licensable activities at the specific premises on persons living and working (including those carrying on business) in the area around the premises which may be disproportionate and unreasonable. The issues will mainly concern noise nuisance, light pollution, noxious smells and litter.

2.16 Public nuisance is given a statutory meaning in many pieces of legislation. It is however not narrowly defined in the 2003 Act and retains its broad common law meaning. It may include in appropriate circumstances the reduction of the living and working amenity and environment of other persons living and working in the area of the licensed premises. Public nuisance may also arise as a result of the adverse effects of artificial light, dust, odour and insects or where its effect is prejudicial to health.

2.18 As with all conditions, those relating to noise nuisance may not be appropriate in certain circumstances where provisions in other legislation adequately protect those living in the area of the premises. But as stated earlier in this Guidance, the approach of licensing authorities and responsible authorities should be one of prevention and when their powers are engaged, licensing authorities should be aware of the fact that other legislation may not adequately cover concerns raised in relevant representations and additional conditions may be appropriate.

Protection of Children from harm

2.22 The protection of children from harm includes the protection of children from moral, psychological and physical harm. This includes not only protecting children from the harms associated directly to alcohol consumption but also wider harms such as exposure to strong language and sexual expletives (for example, in the context of exposure to certain films or adult entertainment). Licensing authorities must also consider the need to protect children from sexual exploitation when undertaking licensing functions.

2.23 The Government believes that it is completely unacceptable to sell alcohol to children. Conditions relating to the access of children where alcohol is sold and which are appropriate to protect them from harm should be carefully considered.

- A member or members of the current management have been convicted for serving alcohol to minors or with a reputation for allowing underage drinking (other than in the context of the exemption in the 2003 Act relating to 16 and 17 year olds consuming beer, wine and cider when accompanied by an adult during a table meal);

2.26 Licensing authorities and responsible authorities should expect applicants, when preparing an operating schedule or club operating schedule, to set out the steps to be taken to protect children from harm when on the premises.

2.28 Please see also Chapter 10 for details about the Licensing Act 2003 (Mandatory Licensing Conditions) Order 2010.

2.29 Licensing authorities should give considerable weight to representations about child protection matters. In addition to the responsible authority whose functions relate directly to child protection, the Director Public Health may also have access to relevant evidence to inform such representations. These representations may include, amongst other things, the use of health data about the harms that alcohol can cause to underage drinkers. Where a responsible authority, or other person, presents evidence to the licensing authority linking specific premises with harms to children (such as ambulance data or emergency department attendances by persons under 18 year old with alcohol-related illness or injuries) this evidence should be considered, and the licensing authority should also consider what action is appropriate to ensure this licensing objective is effectively enforced. In relation to applications for the grant of a licence in areas where evidence is presented on high levels of alcohol-related harms in persons aged under 18, it is recommended that the licensing authority considers what conditions may be appropriate to ensure that this objective is promoted effectively.

Offences relating to the sale and supply of alcohol to children

2.32 Licensing authorities are expected to maintain close contact with the police, young offenders' teams and trading standards officers (who can carry out test purchases under section 154 of the 2003 Act) about the extent of unlawful sales and consumption of alcohol by minors and to be involved in the development of any strategies to control or prevent these unlawful activities and to pursue prosecutions. Licensing authorities, alongside the police, are prosecuting authorities for the purposes of these offences, except for the offences under section 147A (persistently selling alcohol to children). Where, as a matter of policy, warnings are given to retailers prior to any decision to prosecute in respect of an offence, it is important that each of the enforcement arms should be aware of the warnings each of them has given.

The following relevant section of RBWM Licensing Policy (2016 – 2021):-

9. Promoting the Prevention of Public Nuisance

Where relevant representations are made, the Licensing Authority will have particular regard to the following issues in relation to the public nuisance objective:

- The disposal of waste, particularly glass
- The use and maintenance of plant, including air extraction and ventilation systems
- Litter in the vicinity of the premises
- Noise from deliveries / collections to and from the premises
- Measures to control behaviour and queues
- Whether door supervisors are able to stay at the entrance to encourage quiet departure
- The provision of Hackney Carriage / Private Hire services at the premises
- Signs on doors and on tables encouraging consideration to the neighbours

6. Key Strategies for 2016 – 2021

6.1 Framework Hours

The current staggered closing times of licensed premises, that has developed since 2005 in the Royal Borough, has helped to reduce the problems associated with large numbers of people leaving premises at the same time and reduced congestion at taxi ranks and fast food outlets. However, the later opening hours have brought increased levels of crime, disorder and nuisance. Responsible Authorities, local residents and local Councillors have reported many issues, including noise, anti-social behaviour and litter, which are having an adverse impact on their quality of life. In particular, there has been an increase in violent crime in Windsor town centre between the hours of 00:00 and 04:00.

Having considered the evidence of alcohol related crime, disorder and anti-social behaviour, the number of late night premises and, in particular, the social, practical and regulatory impacts on the morning after the night before, the Licensing Authority

has adopted a Framework Hours Policy. This Framework Hours Policy will apply to new and variation applications.

The Framework Hours are: Premises Type:	Commencement Hour for Licensable Activities No earlier than :	Terminal Hour for Licensable Activities No later than:
• Off licence	• 09:00am	• 11:00pm
• Restaurant	• 09:00am	• 01:00am
• Pub/Bars/Night Clubs	• 10:00am	• 02:00am
• Takeaways	• n/a	• 02:00am

Have greater freedom to operate outside framework hours. Such venues are predominantly seated. Examples include:

- Theatres
- Cinemas
- Qualifying Clubs

For the purpose of this policy, premises shall be considered as a restaurant or café if the sale of alcohol is made only to seated customers who are also dining and where this is a condition of the licence, or a condition volunteered in the Operating Schedule for the premises. Where such conditions have not been offered, the premises will be treated as a public house.

Framework Hours are intended to guide applicants on the Licensing Authority's expectations when preparing their Operating Schedule. However, if no relevant representations are received, the application will be granted by the Licensing Authority under delegated powers.

Any conditions setting out hours of premises refers, unless otherwise stated, to the hours during which licensable activities may take place pursuant to the Premises Licence or Club premises Certificate. The Licensing Authority expects the premises to close thirty minutes after the terminal hour for the latest licensable activity.

6.4 Wider Community Interest

The Licensing Authority considers that its licensing functions are exercised in the public interest, furthermore that the licensing authority is under a duty to take any steps with a view to the promotion of the licensing objectives in the interests of the wider community and not just those of the individual licence holder.

The Licensing Authority will have particular regard to those applications in close proximity to residential premises and the likely effect on the promotion of the licensing objectives in such circumstances. Subject to any relevant representations, the Licensing Authority will have particular regard to:

- The nature of the activities
- The character of the surrounding area

E) Observations.

The Sub Committee is obliged to determine this application with a view to promoting the licensing objectives which are:

- The prevention of crime and disorder;
- Public safety;
- The prevention of public nuisance
- The protection of children from harm.

In making its decision, the Committee is also obliged to have regard to national guidance and the Council's own Licensing Policy. Of course, the Committee must have regard to all of the representations made and the evidence it hears.

The Committee must take such of the following steps as it considers appropriate for the promotion of the licensing objectives:

- Grant the application as asked.
- Modify the conditions of the licence, by altering or omitting or adding to them.
- Reject the whole or part of the application.

30/11/11

5868280

**Application for a premises licence to be granted
under the Licensing Act 2003**

PLEASE READ THE FOLLOWING INSTRUCTIONS FIRST

Before completing this form please read the guidance notes at the end of the form. If you are completing this form by hand please write legibly in block capitals. In all cases ensure that your answers are inside the boxes and written in black ink. Use additional sheets if necessary.

You may wish to keep a copy of the completed form for your records.

I/We CHARAL PATEL

(Insert name(s) of applicant)

apply for a premises licence under section 17 of the Licensing Act 2003 for the premises described in Part 1 below (the premises) and I/we are making this application to you as the relevant licensing authority in accordance with section 12 of the Licensing Act 2003

Part 1 – Premises details

Postal address of premises or, if none, ordnance survey map reference or description COSTCUTTER 113-117 SPRINGFIELD ROAD			
Post town	WINDSOR	Postcode	SL4 3PZ

Telephone number at premises (if any)	
Non-domestic rateable value of premises	£26250

Part 2 - Applicant details

Please state whether you are applying for a premises licence as Please tick as appropriate

- a) an individual or individuals * please complete section (A)
- b) a person other than an individual *
 - i as a limited company/limited liability partnership please complete section (B)
 - ii as a partnership (other than limited liability) please complete section (B)
 - iii as an unincorporated association or please complete section (B)
 - iv other (for example a statutory corporation) please complete section (B)
- c) a recognised club please complete section (B)
- d) a charity please complete section (B)

- e) the proprietor of an educational establishment please complete section (B)
- f) a health service body please complete section (B)
- g) a person who is registered under Part 2 of the Care Standards Act 2000 (c14) in respect of an independent hospital in Wales please complete section (B)
- ga) a person who is registered under Chapter 2 of Part 1 of the Health and Social Care Act 2008 (within the meaning of that Part) in an independent hospital in England please complete section (B)
- h) the chief officer of police of a police force in England and Wales please complete section (B)

* If you are applying as a person described in (a) or (b) please confirm (by ticking yes to one box below):

- I am carrying on or proposing to carry on a business which involves the use of the premises for licensable activities; or
- I am making the application pursuant to a statutory function or
- a function discharged by virtue of Her Majesty's prerogative

(A) INDIVIDUAL APPLICANTS (fill in as applicable)

Mr <input type="checkbox"/>	Mrs <input checked="" type="checkbox"/>	Miss <input type="checkbox"/>	Ms <input type="checkbox"/>	Other Title (for example, Rev)	
Surname PATEL			First names CHARUL		
Date of birth 6/10/76 over		I am 18 years old or		<input checked="" type="checkbox"/>	Please tick yes
Nationality BRITISH					
Current residential address if different from premises address		4 MARBECK CLOSE			
Post town	WINDSOR			Postcode	SL4 5RB
Daytime contact telephone number					
E-mail address (optional)					

SECOND INDIVIDUAL APPLICANT (if applicable)

Mr <input type="checkbox"/>	Mrs <input type="checkbox"/>	Miss <input type="checkbox"/>	Ms <input type="checkbox"/>	Other Title (for example, Rev)	
-----------------------------	------------------------------	-------------------------------	-----------------------------	--------------------------------	--

When do you want the premises licence to start?

DD	MM	YYYY
0	1	12 2 0 18

If you wish the licence to be valid only for a limited period, when do you want it to end?

DD	MM	YYYY

Please give a general description of the premises (please read guidance note 1)

The premises will be a convenience store. The application is off sales only. Fresh food and all other types of goods will be sold including toiletries, household, frozen food, newspapers etc.

If 5,000 or more people are expected to attend the premises at any one time, please state the number expected to attend.

What licensable activities do you intend to carry on from the premises?

(please see sections 1 and 14 and Schedules 1 and 2 to the Licensing Act 2003)

Provision of regulated entertainment (please read guidance note 2)

Please tick all that apply

- a) plays (if ticking yes, fill in box A)
- b) films (if ticking yes, fill in box B)
- c) indoor sporting events (if ticking yes, fill in box C)
- d) boxing or wrestling entertainment (if ticking yes, fill in box D)
- e) live music (if ticking yes, fill in box E)
- f) recorded music (if ticking yes, fill in box F)
- g) performances of dance (if ticking yes, fill in box G)
- h) anything of a similar description to that falling within (e), (f) or (g) (if ticking yes, fill in box H)

Surname		First names	
Date of birth over		I am 18 years old or	<input type="checkbox"/> Please tick yes
Nationality			
Current residential address if different from premises address			
Post town		Postcode	
Daytime contact telephone number			
E-mail address (optional)			

(B) OTHER APPLICANTS

Please provide name and registered address of applicant in full. Where appropriate please give any registered number. In the case of a partnership or other joint venture (other than a body corporate), please give the name and address of each party concerned.

Name
Address
Registered number (where applicable)
Description of applicant (for example, partnership, company, unincorporated association etc.)
Telephone number (if any)
E-mail address (optional)

Part 3 Operating Schedule

Provision of late night refreshment (if ticking yes, fill in box I)

Supply of alcohol (if ticking yes, fill in box J)

In all cases complete boxes K, L and M

A

Plays Standard days and timings (please read guidance note 7)			Will the performance of a play take place indoors or outdoors or both – please tick (please read guidance note 3)	Indoors	<input type="checkbox"/>
				Outdoors	<input type="checkbox"/>
Day	Start	Finish		Both	<input type="checkbox"/>
Mon			Please give further details here (please read guidance note 4)		
Tue					
Wed			State any seasonal variations for performing plays (please read guidance note 5)		
Thur					
Fri			on standard timings. Where you intend to use the premises for the performance of plays at different times to those listed in the column on the left, please list (please read guidance note 6)		
Sat					
Sun					

B

Films Standard days and timings (please read guidance note 7)			Will the exhibition of films take place indoors or outdoors or both – please tick (please read guidance note 3)		Indoors <input type="checkbox"/>	
					Outdoors <input type="checkbox"/>	
					Both <input type="checkbox"/>	
Day	Start	Finish	Please give further details here (please read guidance note 4)			
Mon						
Tue						
Wed			State any seasonal variations for the exhibition of films (please read guidance note 5)			
Thur						
Fri						
Sat			Non standard timings. Where you intend to use the premises for the exhibition of films at different times to those listed in the column on the left, please list (please read guidance note 6)			
Sun						

C

Indoor sporting events Standard days and timings (please read guidance note 7)			<u>Please give further details</u> (please read guidance note 4)
Day	Start	Finish	
Mon			
Tue			<u>State any seasonal variations for indoor sporting events</u> (please read guidance note 5)
Wed			
Thur			
Fri			<u>Non standard timings. Where you intend to use the premises for indoor sporting events at different times to those listed in the column on the left, please list</u> (please read guidance note 6)
Sat			
Sun			

D

Boxing or wrestling entertainments Standard days and timings (please read guidance note 7)			Will the boxing or wrestling entertainment take place indoors or outdoors or both – please tick (please read guidance note 3)		Indoors <input type="checkbox"/>
					Outdoors <input type="checkbox"/>
Day	Start	Finish	Both <input type="checkbox"/>		
Mon			Please give further details here (please read guidance note 4)		
Tue					
Wed			State any seasonal variations for boxing or wrestling entertainment (please read guidance note 5)		
Thur					
Fri			on standard timings. Where you intend to use the premises for boxing or wrestling entertainment at different times to those listed in the column on the left, please list (please read guidance note 6)		
Sat					
Sun					

E

Live music Standard days and timings (please read guidance note 7)			Will the performance of live music take place indoors or outdoors or both – please tick (please read guidance note 3)	
			Indoors	<input type="checkbox"/>
			Outdoors	<input type="checkbox"/>
			Both	<input type="checkbox"/>
Day	Start	Finish	Please give further details here (please read guidance note 4)	
Mon				
Tue			State any seasonal variations for the performance of live music (please read guidance note 5)	
Wed				
Thur			On standard timings. Where you intend to use the premises for the performance of live music at different times to those listed in the column on the left, please list (please read guidance note 6)	
Fri				
Sat				
Sun				

F

Recorded music Standard days and timings (please read guidance note 7)			Will the playing of recorded music take place indoors or outdoors or both – please tick (please read guidance note 3)		Indoors <input type="checkbox"/>
					Outdoors <input type="checkbox"/>
					Both <input type="checkbox"/>
Day	Start	Finish	Please give further details here (please read guidance note 4)		
Mon					
Tue					
Wed			State any seasonal variations for the playing of recorded music (please read guidance note 5)		
Thur					
Fri					
Sat			Do not use standard timings. Where you intend to use the premises for the playing of recorded music at different times to those listed in the column on the left, please list (please read guidance note 6)		
Sun					

G

Performances of dance Standard days and timings (please read guidance note 7)			Will the performance of dance take place indoors or outdoors or both – please tick (please read guidance note 3)	Indoors	<input type="checkbox"/>
Day	Start	Finish		Outdoors	<input type="checkbox"/>
Mon			Please give further details here (please read guidance note 4)	Both	<input type="checkbox"/>
Tue					
Wed			State any seasonal variations for the performance of dance (please read guidance note 5)		
Thur					
Fri			When standard timings. Where you intend to use the premises for the performance of dance at different times to those listed in the column on the left, please list (please read guidance note 6)		
Sat					
Sun					

H

<p>Anything of a similar description to that falling within (e), (f) or (g) Standard days and timings (please read guidance note 7)</p>			<p>Please give a description of the type of entertainment you will be providing</p>		
Day	Start	Finish	<p>Will this entertainment take place indoors or outdoors or both – please tick (please read guidance note 3)</p>	Indoors	<input type="checkbox"/>
Mon				Outdoors	<input type="checkbox"/>
				Both	<input type="checkbox"/>
Tue			<p>Please give further details here (please read guidance note 4)</p>		
Wed					
Thur			<p>State any seasonal variations for entertainment of a similar description to that falling within (e), (f) or (g) (please read guidance note 5)</p>		
Fri					
Sat			<p>Non standard timings. Where you intend to use the premises for the entertainment of a similar description to that falling within (e), (f) or (g) at different times to those listed in the column on the left, please list (please read guidance note 6)</p>		
Sun					

I

Late night refreshment Standard days and timings (please read guidance note 7)			Will the provision of late night refreshment take place indoors or outdoors or both – please tick (please read guidance note 3)		Indoors	<input type="checkbox"/>
					Outdoors	<input type="checkbox"/>
Day	Start	Finish	Both <input type="checkbox"/>			
Mon						
			Please give further details here (please read guidance note 4)			
Tue			State any seasonal variations for the provision of late night refreshment (please read guidance note 5)			
Wed						
Thur			on standard timings. Where you intend to use the premises for the provision of late night refreshment at different times, to those listed in the column on the left, please list (please read guidance note 6)			
Fri						
Sat						
Sun						

J

Supply of alcohol Standard days and timings (please read guidance note 7)			Will the supply of alcohol be for consumption – please tick (please read guidance note 8)	On the premises	<input type="checkbox"/>
				Off the premises	<input checked="" type="checkbox"/>
				Both	<input type="checkbox"/>
Day	Start	Finish	State any seasonal variations for the supply of alcohol (please read guidance note 5)		
Mon	0600	2300			
Tue	0600	2300			
Wed	0600	2300			
Thur	0600	2300			
Fri	0600	2300			
Sat	0600	2300			
Sun	0600	2300			
			Non standard timings. Where you intend to use the premises for the supply of alcohol at different times to those listed in the column on the left, please list (please read guidance note 6)		

State the name and details of the individual whom you wish to specify on the licence as designated premises supervisor (Please see declaration about the entitlement to work in the checklist at the end of the form):

Name CHARUL PATEL	
Date of birth 6/10/76	
Address 4 MARBECK CLOSE WINDSOR	
Postcode	SL4 5RB
Personal licence number (if known) 09/00621/LIPERS	
Issuing licensing authority (if known) CROYDON COUNCIL	

K

Please highlight any adult entertainment or services, activities, other entertainment or matters ancillary to the use of the premises that may give rise to concern in respect of children (please read guidance note 9).

None

L

Hours premises are open to the public Standard days and timings (please read guidance note 7)			State any seasonal variations (please read guidance note 5)
Day	Start	Finish	
Mon	0600	2300	<p><u>Non standard timings. Where you intend the premises to be open to the public at different times from those listed in the column on the left, please list</u> (please read guidance note 6)</p>
Tue	0600	2300	
Wed	0600	2300	
Thur	0600	2300	
Fri	0600	2300	
Sat	0600	2300	
Sun	0600	2300	

M Describe the steps you intend to take to promote the four licensing objectives:

a) General – all four licensing objectives (b, c, d and e) (please read guidance note 10)

Staff will be trained before making sales of alcohol in their responsibilities under the Licensing Act 2003. Training will be documented & made available to the Police & authorised officers of the council upon reasonable request.

b) The prevention of crime and disorder

A CCTV system will be in operation at the premises and recorded images shall be retained for a period of 30 days. CCTV images will be provided to the police and other responsible authorities as soon as practicable and in any case within 48 hours of a request for such images, subject of the provisions of the DPA.

A register of refusals of alcohol will be maintained at the premises. The register shall be examined on a regular basis by the duty manager/ DPS and the date and time of each examination will be endorsed in the register. The register will be made available for inspection by the Police and other authorised officers of the council upon reasonable request.

c) Public safety

An incident register will be maintained at the premises and made available to the authorities on request.

d) The prevention of public nuisance

A notice will be on display asking that the customers leave the area quietly and respect the local residents.

All staff at the store will be trained in how to manage any person who they suspect may create a public nuisance in the area of the store. Such people will be asked to leave the area quietly (if safe to do so) an entry will be made in the incident register.

e) The protection of children from harm

The premises will adopt a 'Challenge 25' policy. This means that if a customer purchasing alcohol appears to be under the age of 25 they will be asked for proof of their age, to prove that they are 18 years or older.

Posters will be on display advising customers of the 'Challenge 25' policy.

The only forms of identification that will be accepted at the premises are a passport, UK photo-card driving licences, & cards bearing the 'PASS' hologram.

Checklist:

Please tick to indicate agreement

- I have made or enclosed payment of the fee.
- I have enclosed the plan of the premises.
- I have sent copies of this application and the plan to responsible authorities and others where applicable.
- I have enclosed the consent form completed by the individual I wish to be designated premises supervisor, if applicable.
- I understand that I must now advertise my application.
- I understand that if I do not comply with the above requirements my application will be rejected.
- [Applicable to all individual applicants, including those in a partnership which is not a limited liability partnership, but not companies or limited liability partnerships] I have included documents demonstrating my entitlement to work in the United Kingdom (please read note 15).

IT IS AN OFFENCE, UNDER SECTION 158 OF THE LICENSING ACT 2003, TO MAKE A FALSE STATEMENT IN OR IN CONNECTION WITH THIS APPLICATION. THOSE WHO MAKE A FALSE STATEMENT MAY BE LIABLE ON SUMMARY CONVICTION TO A FINE OF ANY AMOUNT.

IT IS AN OFFENCE UNDER SECTION 24B OF THE IMMIGRATION ACT 1971 FOR A PERSON TO WORK WHEN THEY KNOW, OR HAVE REASONABLE CAUSE TO BELIEVE, THAT THEY ARE DISQUALIFIED FROM DOING SO BY REASON OF THEIR IMMIGRATION STATUS. THOSE WHO EMPLOY AN ADULT WITHOUT LEAVE OR WHO IS SUBJECT TO CONDITIONS AS TO EMPLOYMENT WILL BE LIABLE TO A CIVIL PENALTY UNDER SECTION 15 OF THE IMMIGRATION, ASYLUM AND NATIONALITY ACT 2006 AND PURSUANT TO SECTION 21 OF THE SAME ACT, WILL BE COMMITTING AN OFFENCE WHERE THEY DO SO IN THE KNOWLEDGE, OR WITH REASONABLE CAUSE TO BELIEVE, THAT THE EMPLOYEE IS DISQUALIFIED.

Part 4 – Signatures (please read guidance note 11)

Signature of applicant or applicant's solicitor or other duly authorised agent (see guidance note 12). **If signing on behalf of the applicant, please state in what capacity.**

Declaration	<ul style="list-style-type: none"> • [Applicable to individual applicants only, including those in a partnership which is not a limited liability partnership] I understand I am not entitled to be issued with a licence if I do not have the entitlement to live and work in the UK (or if I am subject to a condition preventing me from doing work relating to the carrying on of a licensable activity) and that my licence will become invalid if I cease to be entitled to live and work in the UK (please read guidance note 15). • The DPS named in this application form is entitled to work in the UK (and is not subject to conditions preventing him or her from doing work relating to a licensable activity) and I have seen a copy of his or her proof of entitlement to work, if appropriate (please see note 15)
Signature	 PAUL SHERRATT
Date	2/11/18
Capacity	Authorised agent

For joint applications, signature of 2nd applicant or 2nd applicant's solicitor or other authorised agent (please read guidance note 13). **If signing on behalf of the applicant, please state in what capacity.**

Signature	
Date	
Capacity	

Contact name (where not previously given) and postal address for correspondence associated with this application (please read guidance note 14)			
Licensing Matters Ltd 54 Fairfield Drive			
Post town	Clitheroe	Postcode	BB7 2PE
Telephone number (if any)	01282 500322		
If you would prefer us to correspond with you by e-mail, your e-mail address (optional) paul@licensingmatters.net			

Consent of individual to being specified as premises supervisor

I CHARUL PATEL

of 4 MARBECK CLOSE
WINDSOR
SL4 5RB

Date of birth: 06/10/76

Place of birth: INDIA (GUJARAT)

Nationality: BRITISH

hereby confirm that I give my consent to be specified as the designated premises supervisor in relation to the application for

PREMISES LICENCE GRANT

by

CHARUL PATEL

relating to a premises licence TBA

for

COSTCUTTER
113-117 SPRINGFIELD ROAD
WINDSOR
SL4 3PZ

and any premises licence to be granted or varied in respect of this application made by

CHARUL PATEL

[name of applicant]

concerning the supply of alcohol at

COSTCUTTER
113-117 SPRINGFIELD ROAD
WINDSOR
SL4 3PZ

I also confirm that I am entitled to work in the United Kingdom and am applying for, intend to apply for or currently hold a personal licence, details of which I set out below.

Personal licence number

09100621/LI PERS

Personal licence issuing authority

CROYDON COUNCIL

Signed

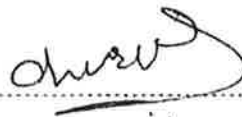

Name (please print)

CHARUL PATEL

Date

23/10/18

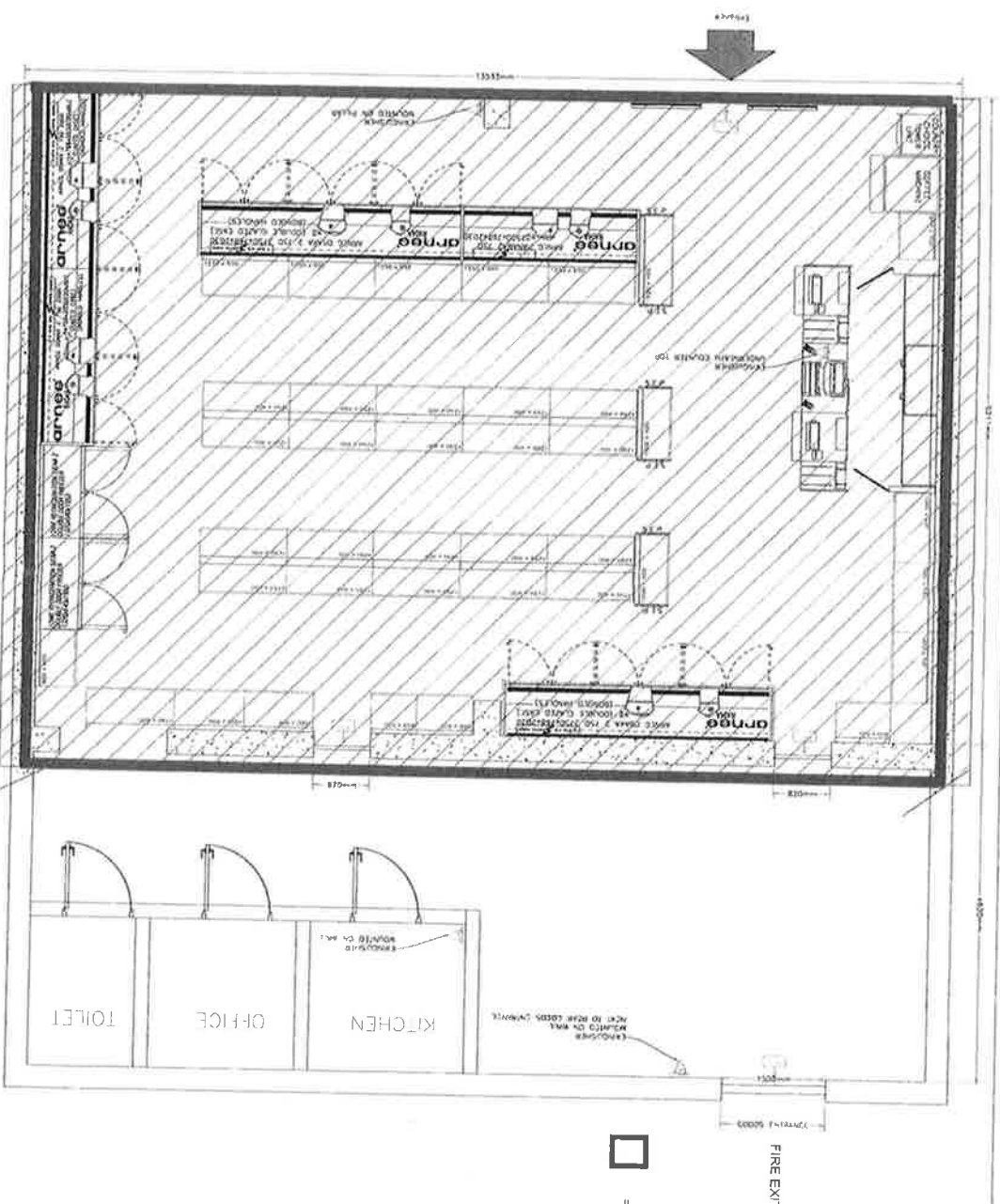

AREA WHERE OFF BWS LICENCE REQUIRED

Costcutter
 Harvest Mills, Common Road
 Dunnington, York, YO19 5RY
 Telephone: 01904 488663 Fax
 01904 489828

DISCLAIMER NOTICE
 THIS DRAWING IS THE PROPERTY OF THE ARCHITECT AND IS NOT TO BE REPRODUCED OR TRANSMITTED IN ANY FORM OR BY ANY MEANS, ELECTRONIC OR MECHANICAL, WITHOUT THE WRITTEN PERMISSION OF THE ARCHITECT. THE ARCHITECT'S LIABILITY IS LIMITED TO THE PROFESSIONAL SERVICES PROVIDED AND DOES NOT EXTEND TO ANY OTHER MATTER. THE ARCHITECT IS NOT RESPONSIBLE FOR ANY CONSTRUCTION DEFECTS OR OMISSIONS WHICH MAY OCCUR IN THE COURSE OF CONSTRUCTION. THE ARCHITECT'S SERVICES ARE PROVIDED ON THE BASIS OF AN ASSUMPTION THAT THE CLIENT HAS OBTAINED ALL NECESSARY PERMITS AND APPROVALS FROM THE RELEVANT AUTHORITIES. THE ARCHITECT'S LIABILITY IS LIMITED TO THE PROFESSIONAL SERVICES PROVIDED AND DOES NOT EXTEND TO ANY OTHER MATTER.



DRAWING NUMBER
 OFF LICENCE REQUEST PLAN

REVISION
 OFF LICENCE REQUEST PLAN

DRAWN BY
 M. BAKER
 COSTCUTTER
 STORE DEVELOPMENT
 MANAGER

DATE
 21/10/18

DETAILS
 SPRINGFIELD ROOM
 WINDSOR
 SL 4/30
 TBC
 TBC

Licensing Act 2003

Costcuter 117117 Springfield Road Windsor SL4 3PZ

Notice of application for a premises licence

Notice is hereby given that Charu Patel has applied to The Royal Borough of Windsor & Maidenhead Council for a premises licence as follows:

1) Sale of alcohol & opening hours 0600 to 2300 Monday to Sunday

Full details of the council website are at:
https://www2.rbm.gov.uk/inf/2/209140/licensing_and_regulation/140/current_licensing_applications

The application can be inspected at the Licensing Section - Royal Borough of Windsor and Maidenhead Town H00 St Ives Road Maidenhead SL6 1RF

Any person wishing to submit relevant representations to this application must give notice in writing to the address shown above by: 30th November 2018

It is an offence liable on conviction to an unlimited fine under Section 158 of the Licensing Act 2003 to knowingly or recklessly make a false statement in connection with this application.

Application submitted by Licensing Matters Ltd 01292 500322

Public notices / News

01753 825111

Follow us on Instagram: @windsorsloughexpress

SOUTHBUCKS DISTRICT COUNCIL

Notice is hereby given that the following Applications have been submitted to the Council for planning permission... SOUTHBUCKS DISTRICT COUNCIL Town and Country Planning Act 1990

SLOUGH BOROUGH COUNCIL Section 14(1) of the Road Traffic Regulation Act 1984 (RTRA 1984) and regulation 3 of the Road Traffic (Temporary Restrictions) Procedure Regulations 1992

Slough Borough Council (Bestobell Road) Order 2018 (Order 41 of 2018) (Order) 1. SLOUGH BOROUGH COUNCIL (Council) gives notice that it has made an Order under section 14(1) of the RTRA 1984 over an area of the highway being Bestobell Road.



Flowers left at the scene

Sections 1, 32, 35, 46 and 53 of the Road Traffic Regulation Act 1984 and regulation 7 of the Local Authorities Traffic Orders (Procedure) (England and Wales) Regulations 1996 as amended.

THE BOROUGH OF SLOUGH WAITING RESTRICTIONS AND PARKING PLACES (CONSOLIDATION) ORDER 2017 (AMENDMENT NO. 1D) ORDER 2018 (Order 42 of 2018)

1. SLOUGH BOROUGH COUNCIL gives notice that it proposes to make the Proposed Order under sections 1, 32, 35, 46 and 53 of the Road Traffic Regulation Act 1984 and any other enabling powers. 2. The effect of the Proposed Order is to make the following changes to Elmhurst Road, Slough:

Family's tribute to cyclist killed in collision

SLOUGH: Tributes have been paid to a 'hardworking, loyal and devoted' family man who died in a road traffic collision in Buckingham Avenue on Friday, November 9.

pronounced dead at the scene. In a statement released by Thames Valley Police, his family said: "Eddie was a hardworking loyal man who was devoted to his family."

Unit, said: "I am appealing to anyone with information or anyone who saw the collision itself, or saw either vehicle before the collision."

SLOUGH BOROUGH COUNCIL Town & Country Planning Act 1990 (as amended) The council has received the following planning applications: Reference Number: P/08249/003

Reference Number: P/02933/069 Location: Iron Mountain, 724-729, Dundee Road, Slough, SL1 4JU Proposal: Construction of new external plant areas to serve new data centre hall.

Reference Number: P/02933/010 Location: Iron Mountain, 724-729, Dundee Road, Slough, SL1 4JU Proposal: Re-clad the front of the building and re-align perimeter fence.

THE ROYAL BOROUGH OF WINDSOR & MAIDENHEAD (B470 HIGH STREET (PART), DATCHET) (TEMPORARY CLOSURE) ORDER 2018

The alternative route for vehicles and pedestrians affected by the Order will be via the B376 The 'Sieve', Queens Road and the B470 Windsor Road. The purpose of the Order is to facilitate works to be executed in and adjacent to the road by Network Rail at the High Street Level Crossing.

GOODS VEHICLE OPERATOR'S LICENCE JRS Hauage Ltd, of 56 Charter Crockett, Hounslow TW4 6AY is applying for a licence to use Aggregate Industries, Colnbrook Depot, Colnbrook Bypass, Colnbrook, Slough, Berkshire SL3 0EB as an operating centre for 1 goods vehicles and 0 trailers.

NOTICE OF APPLICATION TO VARY A PREMISES LICENCE UNDER SECTION 34 OF THE LICENSING ACT 2003 Applicant: A to Z Fresh Ltd Premises: 279 High Street, Slough, SL1 1BN

THE ROYAL BOROUGH OF WINDSOR & MAIDENHEAD GAMBLING ACT 2005 REVIEW OF GAMBLING STATEMENT OF PRINCIPLES

In accordance with section 349 of the Gambling Act 2005 The Royal Borough of Windsor & Maidenhead has to review our Gambling Statement of Principles every three years. Our draft statement was published on 14 November 2018 and you can view our document on our website www.rbwm.gov.uk

Licensing Act 2003 Section 34(2) JRS Hauage Ltd, of 56 Charter Crockett, Hounslow TW4 6AY is applying for a licence to use Aggregate Industries, Colnbrook Depot, Colnbrook Bypass, Colnbrook, Slough, Berkshire SL3 0EB as an operating centre for 1 goods vehicles and 0 trailers.

ANTONIO HUGHES LATE OF BERKSHIRE, DIED THERE ON 21 FEBRUARY 2012 The kin of the above named are requested to apply to BVD, PO Box 2118, Croydon CR9 3QU

GOODS VEHICLE OPERATOR'S LICENCE SANDHU ROADLINES LIMITED of 12 Mansel Close, Slough, SL2 5UG is applying for a licence to use Eurostrage, Station Road, Langley, SL3 6FD as an operating centre for 4 goods vehicles and 4 trailers.

Owners or occupiers of land (including buildings) near the operating centre(s) who believe that their use or enjoyment of that land would be affected, should make written representations to the Traffic Commissioner at Hillcrest House 386 Herehills Lane Leeds LS9 9NF, stating their reasons, within 21 days of this notice.

Katia Russo

From: Rajinder Mann
Sent: 14 November 2018 16:18
To: Katia Russo; Licensing
Subject: RE: New Premise Licence Application for Costcutter - Windsor

Hello Katia,

Hope you are well,

Re: Costcutter - Windsor

Please find the following conditions that we would like to put forward.

*** Proxy sales of alcohol will not be permitted - all staff trained to discourage the sale of alcohol to customers on behalf of children.**

*** Management will ensure ongoing staff training, etc. (All bar staff/staff fully trained and retrained every 6 months which includes to discourage the sale of alcohol to customers on behalf of children).**

*** A Challenge 25 policy shall be operated at the premises at all times. All staff shall require identification of all customers who appear to be less than 25 years old and wish to purchase alcohol.**

Acceptable proof of age will be a PASS approved proof of age card, passport, photographic driving licence, or any identification recognised or approved by either the Licensing Authority or Thames Valley Police.

No other form of identification shall be accepted unless agreed with the Licensing Authority or Thames Valley Police.

***The Premises Licence Holder shall operate and maintain an up-to-date record of refused sales of alcohol, indicating the date, time, reason for refusal and person refusing. The record shall be reviewed from time to time by the Designated Premises Supervisor or premises licence holder. This information shall be made available upon request to the Licensing Authority, TVP and any other Responsible Authorities.**

***Appropriate signage of Challenge 25 policy.**

Kind regards

Mr Rajinder Mann
Fair Trading Officer
Trading Standards Service
Royal Borough of Windsor & Maidenhead
Tinkers Lane
Windsor
Berkshire
SL4 4LR
Tel: 01628 683670

Email: rajinder.mann@rbwm.gov.uk
GCSx Secure Email: rajinder.mann@rbwm.gcsx.gov.uk

Katia Russo

From: paul Sherratt <paul@licensingmatters.net>
Sent: 21 November 2018 11:31
To: Katia Russo
Subject: RE: TS Conditions for Costcutter - Springfield - Windsor

Caution: External email. Think before clicking links or opening attachments.

Hi Katia

I am happy to accept the condition. I was speaking to you as the Licensing Authority as the guidance is clear in that you should not put items on licences that are covered by other legislation or are already law

Kind regards

Paul Sherratt



LICENSING MATTERS

you serve • we protect

Office: 01282 500322

54 Fairfield Drive Clitheroe BB7 2PE

The small print

This e-mail and any files transmitted with it are confidential and may be protected by legal privilege. If you are not the intended recipient, please notify the sender and delete this e-mail from your system. Please do not disclose, copy or use any part of this e-mail and / or any attachments. This e-mail has been scanned for malicious content but the internet is inherently insecure and Licensing Matters Ltd cannot accept any liability for the integrity of this message or its attachments.

Licensing Matters Ltd is a limited company registered in England and Wales, Registered Number 05822732.
Registered office: 54 Fairfield Drive Clitheroe BB7 2PE.

From: Katia Russo <Katia.Russo@RBWM.gov.uk>
Sent: 21 November 2018 11:29
To: paul Sherratt <paul@licensingmatters.net>
Subject: RE: TS Conditions for Costcutter - Springfield - Windsor

Hi Paul,

Could you please contact our Trading Standards Officer on 01628 683670

Thank you,

Katia

From: paul Sherratt <paul@licensingmatters.net>
Sent: 21 November 2018 10:58

Licensing Section 127 Springfield Road
To. Royal Borough of Windsor Windsor Berks. SL4 3PZ
and Maidenhead

Jawn Hall
St Joes Road
Maidenhead
SL6 1RF.

14th Nov. 2018

RECEIVED

15 NOV 2018

LICENSING

Dear Sir

Ref. New Premises Licence

Costcutter 113-117 Springfield Road
Windsor SL4 3PZ.

My main objection to this application
is.

- 1 Opening hours 06.00 hrs - 23.00 hrs Mon-~~Fri~~^{Sun}
- 2 This will mean more late night traffic
- 3 This area of Springfield Rd, has mostly elderly people, which the off licence will encourage late night noise from cars and young people drinking in the road.
- 4 More daytime traffic near a school and nursery

5 . More rubbish (i.e beer cans + bottles) which elderly residents will be left to pick up

I hope that the off licence will be rejected, and Costcutters food store will have to close at 8PM. not 11-PM

Yours faithfully

J. Manger (Mrs)

RECEIVED
15 NOV 2018
LICENSING

126. Springfield Rd
Windsor S44 3PU

License Section.

Dear Sir

Units at 109 Springfield Rd
is a general store and an off
licence open from Ten - 8pm.

There is an application
in the empty shop next door to open
another including off licence to close
at 11pm.

This is really inappropriate
in a residential area, why have a
duplicate next to the established
store and to sell drinks till 11 will
encourage inappropriate behaviour in
a built up area. There are other
such shops within a short distance

RECEIVED

28 NOV 2018

LICENSING

Yours faithfully

B. Birch B.M. BIRCH

122 Springfield Road
Windsor

SL4 3PU

15-11-18

Re. Postcutter 113-117 Springfield Road

Dear Sir,

I would like to object to this application. My main reasons are:—

1. Opening hours 06:00 hrs to 23:00 hrs Monday to Sunday.
2. Will bring noise to a residential area in the evening.
3. More traffic, day and night.
4. More rubbish left along the road and in gardens.
5. Rowdy behaviour, especially in the evening.
6. We already have a convenience store and do not need another one.

RECEIVED

16 NOV 2018

LICENSING

Yours faithfully

S. G. Jones

24 Cedar Court
Birchington Road
Windsor
Berkshire
SL4 3QA

07th December 2018

To Whom It May Concern:

I am writing to object to the proposed *Costcutter* store at 113-117 Springfield Road, Windsor SL4 3PZ. I do not believe this will bring a positive addition to the locality, and the proposed hours for the sale of alcohol will attract problems in the neighbourhood, and risk safety of the residents.

Springfield Road is the heart of this part of Windsor and we already have a perfectly adequate local shop for all the needs of the locals. Encouraging the very early and very late sale of alcohol may portray the wrong impression of this area. There is a real risk of the area being littered, requiring the council to clean up the area much more often, potential anti-social behaviour and could even have an impact on house prices. Research has shown that these longer licencing hours can create a violence and binge drinking – I do not want this happening on my door step.

I **strongly object** to the *Costcutter* store on Springfield Road.

Yours sincerely,



Alex McNeillie

RECEIVED _____
11 DEC 2018
LICENSING _____

24 Cedar Court
Birchington Road
Windsor
Berkshire
SL4 3QA

07th December 2018

To Whom It May Concern:

I am writing to object to the proposed *Costcutter* store at 113-117 Springfield Road, Windsor SL4 3PZ. I do not believe this will bring a positive addition to the locality, and the proposed hours for the sale of alcohol will attract problems in the neighbourhood, and risk safety of the residents.

Springfield Road is the heart of this part of Windsor and we already have a perfectly adequate local shop for all the needs of the locals. Encouraging the very early and very late sale of alcohol may portray the wrong impression of this area. There is a real risk of the area being littered, requiring the council to clean up the area much more often, potential anti-social behaviour and could even have an impact on house prices. Research has shown that these longer licencing hours can create a violence and binge drinking – I do not want this happening on my door step.

I **strongly object** to the *Costcutter* store on Springfield Road.

Yours sincerely,



Pamela Heggie

RECEIVED
11 DEC 2018
LICENSING

From: Harbhajan Singh Baidwan [REDACTED]
Sent: 24 November 2018 12:44
To: Licensing <Licensing@RBWM.gov.uk>
Subject: Proposed Off-Licence and supermarket at 113-117 Springfield Road, Windsor, SL4 3PZ

Licensing Section
Royal Borough of Windsor and Maidenhead
Town Hall
St Ives Road
Maidenhead, SL6 1RF

Harbhajan Singh Baidwan
111 Springfield Road
Windsor, Berkshire
SL4 3PS

23th November 2018

Ref: Proposed Off-Licence and supermarket at 113-117 Springfield Road, Windsor, SL4 3PZ

Dear Sirs and Madame,

We are writing in connection with the above planning application. We have examined the plans and I know the site well. I wish to object strongly to the proposed Off-Licence and supermarket as this would cause the following issues.

1. **Crime and disorder** - The proposed opening hours of the off-Licence from 6.00 am to 11.00 pm shows Lack of awareness of the local residents and lack of responsibility to the community. With the potential increase in crime with the additional availability of Alcohol until late at night will also cause an interrupted sleep of local residents.
2. **The prevention of public nuisance** – The availability of alcohol to purchase for longer hours would potentially encourage youngsters to hang around on the benches nearby the area until late and misbehave in an anti-social behaviour.
3. **The protection of children from harm** – Increase in traffic due to delivery lorries, parking problems for residents and school would present a danger to the local children attending the local school.
4. **No Requirement** – There is no need for an additional shop with an alcohol Licence on a parade of just three commercial properties. It would rather be far more beneficial to provide the diversity of some other trade that local residents and nearby school can benefit.
5. **Notices for public awareness** – There has been no notice in the local newspapers given by the applicant for public awareness since the application was submitted. The notice of application for a Premises Licence was also deliberately delayed to be displayed approximately two weeks later after the application was submitted

Taking all the above facts into consideration, we strongly object the proposed Off-Licence and supermarket at 113-117 Springfield Road, Windsor, Berkshire SL4 3PZ. If this application is to be decided by councillors, please take this as notice that I would like to speak at the meeting of the committee at which this application is expected to be decided. Please let us know as soon as possible the date of the meeting.

Yours Faithfully,

Mr. Harbhajan Singh Baidwan
Mrs. Devinder Kaur Baidwan

[REDACTED]
[REDACTED]

LICENCE APPLICATION

Premises: Costcutler 113-117 SPRINGFIELD RD SL43 PZ

I wish to make objection to the granting of a licence to sell alcohol on the above premises from 06:00 - 23:00 hrs.

This is a residential area and we certainly do not want disturbance by people buying and drinking alcohol and disposing of the cans and bottles in our gardens.

I fail to understand why the Council has even considered allowing the setting up of a convenience store selling the same products as the one adjoining it and which has given us good service for 50 yrs or more.

IS IT FAIR ?

Mahida Dhanraj
128 SPRINGFIELD RD
WINDSOR
SL 4 3 PU.
21 Nov. 2018.

Copy to Councillor D. Duck.

LICENSING
26 NOV 2018
RECEIVED

Thank you for speaking to me this morning as discussed I have written the objections to the application for Off-Licence for you to forward to Royal Borough Windsor and Maidenhead

licensing council along with other objection letters.

I am writing in connection to the Alcohol licence application no: 200140 for 113-117 Springfield Road, Windsor, SL4 3PZ.

To start with let me provide you a background to us;

1. As I mentioned to you, we have a shop that is next door to the proposed shop that has applied for the Alcohol licence.
2. We have been running this business for 15 years and over that period we built a close relationship with the local residents and have got to know them well and we have seen their young children grow up over the years.
3. We have gone out of our way to prevent crime and disorder and made sure we close the shop early so that neighbours are not disturbed late at night as the business is in residential area.
4. We know the children that come into the shop as we know the parents and make sure, they are not able to obtain alcohol and tobacco and are not loitering with the aim of obtaining the aforesaid.

To summarise the reasons why alcohol licence should not be allowed to the proposed applicant:

1. There is no requirement for another shop with an alcohol licence on a parade of just three commercial properties. It would be far more beneficial to provide diversity of another trade that the local residents and next-door school can benefit from.
2. The hours requested for the alcohol licence (from 6.00 am to 11.00 pm) clearly shows a lack of awareness of the local area and lack of responsibility for the neighbours' welfare.
3. There is school in very close proximity to the shops. It would not provide any benefit (in fact it would be to the detriment of the local area) to have another shop selling alcohol and tobacco and more energy drinks. This is an area where the local residents are concerned and we have worked hard to keep the local youngsters away from.
4. Due to the proposed early and late opening times the youngsters will be able to get late night alcohol and sit on the nearby benches disturbing the neighbours and leading to an increase in anti-social behaviour.
5. The increase in traffic due to delivery lorries will not only cause parking problems but would also present a hazard to local children as well as children from the nearby school.
6. The proposed business is a family run business, with very little staff to take care of residents' welfare.

Having discussed the matter with a number of local residents there is a clear worry about this new business hoping to trade alcohol for the reasons outlined. As a consequence, we strongly object to the granting of any licence.

I would be grateful, if the concerns of our customers and local residents are taken into consideration as regards to the proposed application for the alcohol licence. We believe every effort should be made to stop the granting of the licence and preserve the safety, and peacefulness of the local community.

Thank you

Regards
Pam Kaur

Annes News
109 Springfield Road
Windsor
SL4 3PZ

Katia Russo

From: Andrew Smith <[REDACTED]>
Sent: 04 December 2018 12:52
To: Licensing
Subject: Application for a Premises Licence at the proposed Costcutter store at 113-117, Springfield Road, Windsor, SL4 3PZ.

Regarding the above captioned application, We notice that the application is for the 'supply of alcohol (OFF premises) from 06.00 to 23.00 Monday to Sunday.

We note that there is no mention of tobacco in this matter. Is tobacco not to be sold?

The purpose of this missive is to lodge our thoughts on this particular application, so as to ensure that the Licensing Team are fully apprised of the circumstances.

As per the Council website, we notice that there is a body called the Windsor & Maidenhead Local Safeguarding Children Board (LSCB). The Council also, apparently, takes into consideration the 'character' of the surrounding area, litter in the vicinity of the premises, and the 'crime/disorder nuisance potential'. Taking all these points, the first thing that springs to mind is the proximity of the premises to the back entrance to the local junior school.

We already have a convenience store in situ, next door to the subject premises at no. 109. They, no doubt, have their own premises certificate enabling the sale of excisable commodities such as alcohol and tobacco. Thus, do we need a second, somewhat larger 'convenience' store in direct competition next door?

Notwithstanding the distinct possibility of a price war between the two establishments, one can foresee a less than amicable relationship between the two!

It should also be noted that No. 109 has been targeted TWICE by burglars, just for the excisable commodities.

The character of the surrounding area is residential, involving both the 'private' and 'social' housing communities. This area has a steady 'traffic' of youngsters, both 'children' and 'young adults' moving through the Springfield Road/York Road area, en route to either the town centre or the 'skate park', just beyond the underpass. The Council will be well aware of the vandal element in our area, given the number of times the underpass wall is repainted!! Drinks, both canned and bottled are purchased locally(whether or not alcoholic) and, once consumed, the can/bottle is tossed into any adjacent front garden, into the road, etc. etc. If it is a glass container, potentially dangerous broken glass is scattered around, all too predictably. Litter is already a growing menace in this locality.

Just have a look regularly, at the cul-de-sac end of York Road! This application by Costcutter (through their agents) can only exacerbate this problem.

Given that this is a residential area, the proposed 'operating hours' will mean that there will be a certain amount of 'light pollution' adding to that emitted by the new style street lighting. Once the premises are fitted out, no doubt including white light L.E.D.'s and/or fluorescent lights, this will give a problem to residences opposite, some of which may well include children trying to sleep!

We trust that due consideration will be given to this epistle, when the merits-or otherwise- are considered by the Council.

We remain'

Yours Faithfully,
Andrew & Vivienne Smith
55 York Road,
Windsor.
SL4 3PA

Licensing

From: Larry Quirke [REDACTED]
Sent: 10 December 2018 19:01
To: Licensing
Cc: Cllr Quick
Subject: Re: Costcutter Springfield Road

Caution: External email. Think before clicking links or opening attachments.

Dear RBWM licencing Department,

Wish to raise an objection to the licencing application ref 200140 for 113-117 Springfield Road, Windsor, SL4 3PZ.

My reasons are:

- 1, There is already a facility in Springfield road that provides a service to the local community.
- 2, Opening hours of 7am to 11pm will disturb many of the residence who are elderly.
- 3, Deliveries will only compound the existing traffic problems.

Please can acknowledge receipt of this e mail by return?

Kind regards,

Larry Quirke.
125 Springfield Rd.
Windsor Berkshire.
SL4 3PZ.

Katia Russo

From: Cllr Quick
Sent: 14 November 2018 15:29
To: Cllr Bowden; Katia Russo
Subject: Re: Objection letter for application for Off-Licence for 113-117 Springfield Road

Dear Katia

I like Cllr. Bowden have been contacted by objectors regarding the application for a licence to sell alcohol from 113-117 Springfield Road. Apart from a stationer and a licensed convenience store the road and surrounding roads are exclusively quiet residential houses and bungalows.

The existing shop closes at 8.00pm so there is no disturbance or nuisance caused in the evenings. If a new establishment is granted permission to sell alcohol as off sales until 11.00pm it will create noise and potentially anti-social behaviour spilling out onto the neighbouring grass area right under resident's windows. It will change the nature of the area.

I strongly agree with Cllr. Bowden's request for this to come to panel unless officers have already decided to refuse the application.

Kind Regards

Cllr. Quick
Clewer East

Katia Russo

From: Cllr Bowden
Sent: 13 November 2018 23:53
To: Katia Russo; Cllr Quick
Subject: Fwd: Objection letter for application for Off-Licence for 113-117 Springfield Road

Dear Katia

Below is a letter received from the licensed premises - within 10 metres of the application in Springfield Road.

I received a telephone call from the objector who had been approached by a number of residents expressing their concern over the application.

The objector is self policing their own sales through knowledge of families and residents over a number of years.

The new applicant will be unable to do this.

I support her objection, and this application should go to the licensing panel. I am a member of this panel, but I will absent myself and speak on behalf of the applicant and the concerned residents.

Regards

Cllr John Bowden
Clewer East
07905906957

Sent from my iPad

W. Quick

Steve Smith

Pam
109 Springfield Road
Windsor
SL4 3PZ

Petition from Springfield Road and surrounding area

Objection to the proposed off-licence and supermarket at 113-117 Springfield road, Windsor, SL4 3PZ

We object to proposed off-licence and supermarket as this would cause the following issues:

- 1. Crime and disorder** - The proposed opening hours of the off-Licence from 6.00 am to 11.00 pm shows lack of awareness of the local area and a lack of responsibility to the community. With the potential increase in crime with the additional availability of Alcohol until late.
- 2. The prevention of public nuisance** - The availability of alcohol to purchase for longer hours would potentially encourage youngsters to hang around on the benches nearby the area until late and misbehave in an anti-social behaviour.
- 3. The protection of children from harm** - Increase in traffic due to delivery Lorries, parking problems for residence and school would present a danger to the local children and the children attending local school.
- 4. No Requirement** - There is no requirement for another shop with an alcohol licence on a parade of just three commercial properties, it would be far more beneficial to provide the diversity of another trade that locals residents and next door school can benefit from

If you agree with these Points please sign the petition below

Thank you

Name	Address	Signature	Date
B. URMAN	8 PEEL CLOSE	B. Urmann	21-11-18
S. Smau	Westmead	S. Smau	21/11/18
A. Meakes	Princess Av	A. Meakes	21-11-18
E. Boyle	34 PEEL CLOSE	E. Boyle	21-11-18
J. Killeen	27 Berkeley Avenue	J. Killeen	21-11-18
C. Kelly	6 Westmead	C. Kelly	21/11/18
P. HAIG	79 Springfield Rd	P. Haig	21/11/18
C. Tomasso	5 Upcroft	C. Tomasso	21/11/18
T. Dancy	128 Springfield Rd	T. Dancy	21/11/18
J. Boyle	109 SPRINGFIELD RD	J. Boyle	21/11/18
S. G. Jones	122 Springfield Rd	S. G. Jones	21/11/18
M. Redmond	4 SPRINGFIELD RD	M. Redmond	21-11-18
D. Baker	2 DUNSON CLOSE	D. Baker	21 11 18
M. Dangerfield	2 Almond Close	M. Dangerfield	21 11 18

Name	Address	Signature	Date
J. Hamlin	104 Springfield Rd	J. Hamlin	21.11.18
Brian King	32 Pricot Road	B King	21.11.18
Dawn Curran	136 Springfield Rd	D Curran	21.11.18
Arie Harkin	2 WESTMEAD	AH	21/11/18
JAKE Arnold	2 WESTMEAD RD	AH	21.11.18
Peggy Outwater	2 York Avenue	PAO	21.11.18
CLIVE HOLLAND	108 SPRINGFIELD ROAD	C.F. Holland	21.11.18
Sam Jones	33 Victor Road	S Jones	21.11.18
Jane King	17 Berkeley	J King	21.11.18
Man Bell	7 Riverway	M Bell	21/11/18
Je Beker	44 York Rd.	J Beker	21.11.18
J. Hole	64 Berkeley Ave	J Hole	"
J. BAKER	1A SPRINGFIELD RD	J BAKER	21.11.18
E Mealen	85 Bolton Rd	E Mealen	21.11.18
D. Coumbe	31 Upcroft	D Coumbe	21.11.18
P. HEGGE	2 CEDAR COURT, BRIGHAMTON RD	P. Hegge	21/11/18
I mull	32A WESTMEAD	I mull	21/11/18
K. Dorrett	10 Clewer ave	K Dorrett	21/11/18
J JARROLD	2 DYSON CL	J Jarrold	21.11.18
L WRIGHT	34 UP CROFT	L Wright	21.11.18
E. SHARKE	36 SPRINGFIELD	E Sharke	21/11/18
R McEvoy	134 Springfield Rd	R McEvoy	21.11.18
S. Redmond	46 York Road	S. Redmond	21/11/18
M. Burt	8 York Rd	M Burt	21/11/18

Name	Address	Signature	Date
Jaiga Kaluini	56 York Road		21.11.18.
JENNIFER McGRATH	16 ALBANY RD		21.11.18
Chelsea Harris	1 Westmead.		21/11/18.
KAREN PAGE	14 VISCOUNT COURT VANSITTART	K page	21-11-18
CBrown	50 WILHELMIA ST 5243PG		21.11.18
A. A. Jones	144 VALERIES ONKHEAD SCHOOL		21/11/18
BE JONES	54 DUNCROFT WINDSOR		21/11/18
Laura Murray	87 Fernight Place		21/11/18
Lisa Fitzgerald	6 Aragon Court Windsor		21/11/18.
A Evans	33 Clifton Rd	A Evans.	21/11/18.
A. Brophy	17 NELSON PI		21/11/18
J. Brazier	Coney Close		21/11/18
Ben Watkins	366 Upcroft		21/11/18
John Cooper	47 Bulkeley		21/11/18
CHRISTOPHER DE FALOEIA	37 SPRINGFIELD RD		21/11/18
Awen Spink	98 Springfields RD		21/11/18
Viviane Callaway	22 PEEL CLOSE		21/11/18
Clare Adams	Spinkfield Rd		21/11/18
Paula Menzies	Westmead		21/11/18
Anna Martini	Bulkeley Avenue	Ann Martini	21/11/18
Sharon	Peel Close		21/11/18
M. G. G.	Springfield Rd		21/11/18.
L. Moran	11 Springfield	L Moran	21/11/18
B. S. G.	126 Springfield Rd		23.11.18

Name	Address	Signature	Date
April	24 Clewer Avenue	April	21/11/18
Mauseen	30 Peel Close	M. Dea	21/11/18
Dunbar	47 York Road	Dunbar	21/11/18
J. Creaney	51 Ballycreevy	J. Creaney	21-11-18
Merida	9 Peel Close	Merida	21.11.18
M. Davis	8 W. M. ERK	M. Davis	21.11.18
Michael Morris	42 Park Hill, Windsor SL4 5GE	Michael Morris	21/11/18
Emma Featerra	2 Broadwell SL4 4NR	Emma Featerra	21/11/18
MARIN TAYLOR	41, PEEL CLOSE	M. Taylor	21/11/18
Sel Husain	21 Kings Rd	Sel Husain	21/11/18
A. Shorjo	14 Green Lane	A. Shorjo	21/11/18
Michael Cech	The Lawns Nursery	Michael Cech	21/11/18
Karen Lane	19 Gosmore SL4 5TH	K. Lane	21/11/18
Kelly St Claire	12 Woodland Ave, SL4 4AC	K. St Claire	21/11/18
Lesley Godfrey	67 Princess Ave SL4 3LX	L. Godfrey	21.11.18
Debbie Pule	13 Sycamore Ct.	Debbie Pule	22.11.18
G. Hayes	10 Upcroft	G. Hayes	21-11-18
Emma B	8a Westmead	E. B.	21.11.18
Joe NM	8A WESTMEAD	Joe NM	21.11.18
L. Dudley	12A Westmead	L. Dudley	21.11.18
P. Flynn	39 Elm Road	P. Flynn	21/11/18
Wagne Babo	32 Westmead	Wagne Babo	21/11/18
Maggie Bale	Oakfield Sch	Maggie Bale	21/11/18
Loretta O'Connell	OAKFIELD SCH	Loretta O'Connell	21.11.18

Name	Address	Signature	Date
Amhaud Hallett	12 Springfield Close		21/11/18
M. Letherington	13 Martin Close, Windsor		21/11/18
Newson Kennealy	33 Westmead		21/11/18
Giles Kay	Springfield Rd		22/11/18
Olliver Kay	Springfield Rd		22/11/18
James Kay	Springfield Rd		22/11/18
Roy Frost	Springfield Close		22/11/18
Amy Caplin	33 Clewer Newtown		22/11/18
H.S. Bowdman	110 Springfield Road		22/11/18
Ken Jones	18 Oak Trees Ash		23/11/18
Robert Kerra	5 Cedar Court		23/11/18
Andrew Smith	12 of 33, Wil. Leeve's Way		23/11/18
NELME GUY	Stamonds House 3rd		23/11/18
J. GRAY	PRINCESS AV 52		24/11/18
GRAHAM Young	69 BULLOCKLEY AVE.		24/11/18
A. M. WELLS	24 CEDAR COURT BRACKENHURD		24/11/18
M. Davis	4a Westmead		24/11/18
A. Fisher	52 Springfield Rd		25/11/18
E. Quirk	45, York Road		25/11/18
e. w. w. w. w.	Windsor Ave. J		26/11/18
A. WARREN	25 College Cres		29/11/18
A. HARKNESS	57 BULLOCKLEY AVE		30/11/18
Jatinder Singh	6 Fuldall Road		30/11/18
Tom Quirk	4-5 York Road		4/12/18

Name	Address	Signature	Date
J Manger	127 Springfield Rd	J Manger	1/12/18
B. Wells	Swindon Close	B. Wells	1/12/18
J P Sleepers	5 Down Lane	J P Sleepers	5/12/18
REID OFFICE SUPPLIES	107 SPRINGFIELD RD	Reid	10/12/18
ANA Cercia	263 DEDWORTH RD	Ana Cercia	10/12/18
G. Payne-Allen	33 ALMA RD	G. Payne-Allen	10/12/18
J SPINK	5 Springfield Close	J SPINK	10/12/18
N. Clark	17 Springfield Road	N. Clark	10/12/18
M Hall	Pipers, Hatch Lane,	M Hall	10/12/18
The Alma Public House	61 Springfield Road	M Hall	10/12/18
Starc Motors	2 Elm Road	[Signature]	10/12/18
TOP SHOP.	28 St Leonards Rd.	[Signature]	10/12/18
Growth stores	452 St Leonards Rd.	Growth	10/12/18
Ravi Express Food	125 Winsor	R. Singh	10/12-18
ALAN STORE	29 SINSOR	[Signature]	10/12/18
JESSICA SHOP	SLY SAN 29 CLERACE ROAD	[Signature]	10/12/18
Z BIERNAT	1 Lombard Close SLY SPY	Z Biernat	10/12/18
B. JAMES	2 Causeway Close SLY SPY	B. James	10/12/18
P. JAMES	"	P. James	"
Leha	Alma Road	Leha	10/12/18
P. Owen	Elm Road	[Signature]	10/12/18
S Birdman	York Ave	[Signature]	10/12/18
J. Dennison	MANTLE Close	[Signature]	10/12/18
M GIBBONS	6 Villages Ct Windsor	[Signature]	10/12/18

PREMISES LOCATION



